



The MH lifts constitute a series of small service lifts with multiple uses for the transport of parcels, pieces, etc; in stores, shops, workshops; as dumbwaiters in bars, coffee houses, document lifts in banks and offices; as surgical instruments lifts in clinics, hospitals, etc.



The MTH lifts correspond to a model of service lift with capacity for medium loads and suitable for transport of small trolleys or loading by handcart. For these service lifts the serving height is levelled with the floor of the stop, they have several uses, as for example in hotels for the laundry and restaurant services, in stores for the transports of parcels or in factories for every solution of vertical transports only for goods

These service lifts are in accordance with Machine Directive 89/392/CEE. They are supplied with CE mark.

Their standard fabrication and rigid quality controls make these elevators lasting and reliable products; at the same time as it is a product with a very competitive price.

Manufacture of modular elements, prefabricated electrical installation, ready to plug in, as well as pre-assembly of several elements reduce considerably the installation time

Ample combination of dimensions cover all needs. They are supplied in two different finishes; in baked enamel paint and in stainless steel, for both doors and lift-car

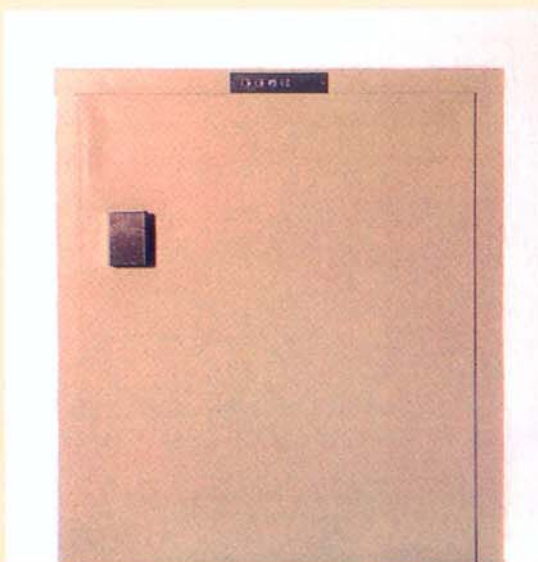



CHARACTERISTICS MODEL MH

TYPE OF DRIVE hydraulically operated with low noise level; possibility of installation with a minimum height from the last stop to the shaft ceiling. Electric for travel longer than 8 meters; traction lift with counterweight and machine at the top.

SUPPLIED in two different versions: to be installed on a wall or with self-supporting structure.

All material and accessories necessary for the total installation and perfect operating are included.

LIFT-CAR. With up to 3 possible openings on one stop level. A supporting tray is included in the standard model. Car doors available if required.

DOORS. Vertical bi-parting door with lock and security electrical contact. Doors automatically operated available as well fire rated door (PF-60).; Machine access door available.

BUTTONS PANNELS. Push-buttons for calling and sending to all floors, with pilot lights indicating engaged position of lift and an acoustic signal to indicate arrival. All these elements function at low 24v tension as a safety measure.



MH

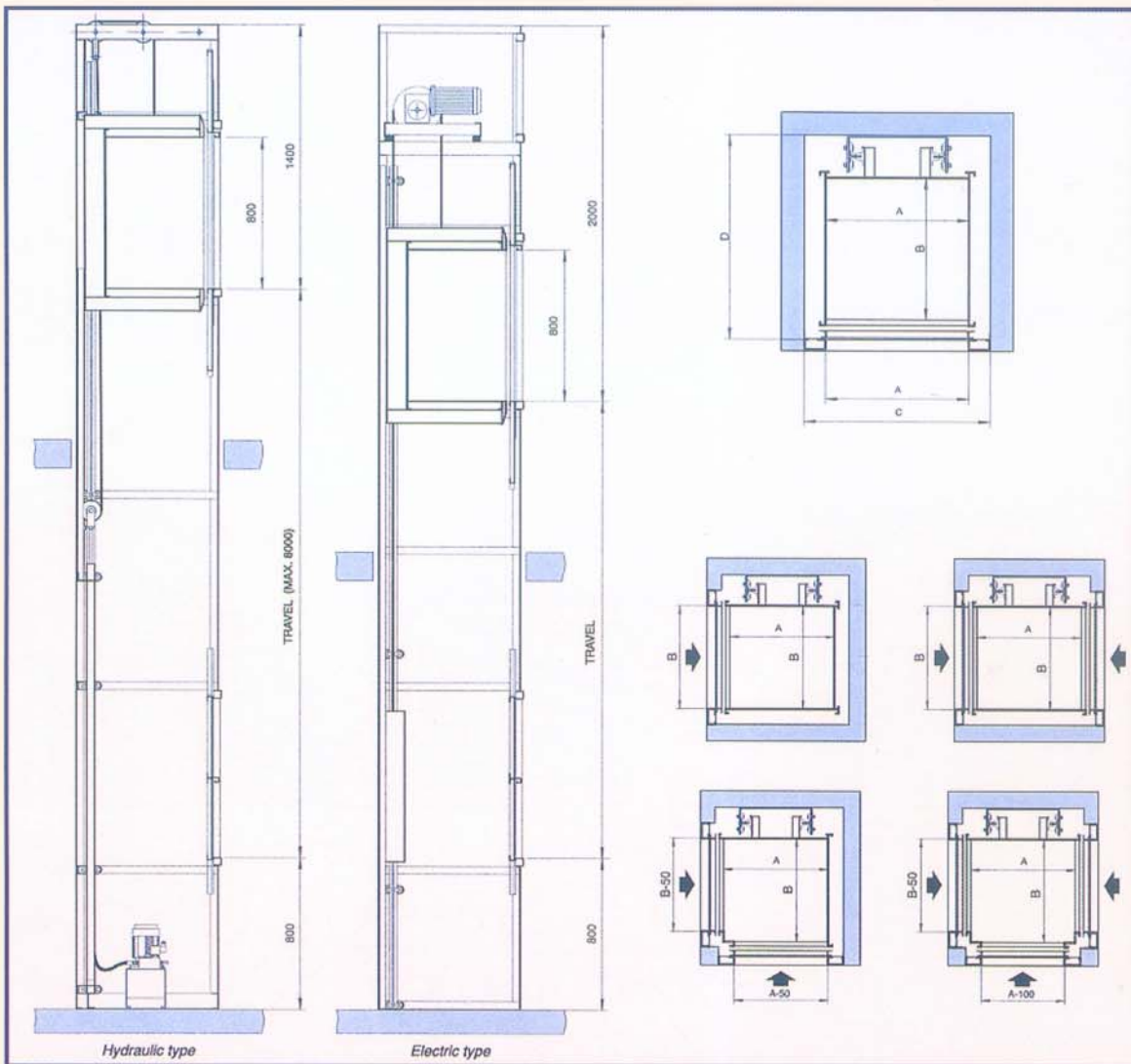

CAR AND SHAFT DIMENSIONS

Installation	A	B	C	D
FIXED ON WALL	350 - 700	350 - 700	A + 150	B + 225
FIXED ON WALL	350 - 700	350 - 700	A + 280	B + 310

MOTOR POWER

Model	Hydraulic type	Electric type
MH 50 (50Kg).	0,55 KW	0, 37 KW
MH 100 (100Kg).	0,75KW	0, 55 KW



CHARACTERISTICS MODEL MTH

TYPE OF DRIVE

hydraulically operated with low noise level; possibility of installation with a minimum height from the last stop to the shaft ceiling. NO special location requirements for the hydraulic power unit.

SUPPLIED in two different versions: to be installed on a wall or with self-supporting structure.

accessories necessary for the total installation and perfect operating are included

LIFT-CAR. With up to 3 possible openings on one stop level.

DOORS. Swing hinged doors, fire rated PF-60., with lock and security electrical contact. Vertical bi-parting door available if required.

BUTTONS PANNELS. Push- buttons for calling and sending to all floors, with pilot lights indicating engaged position of lift and an acoustic signal to indicate arrival. All these elements function at low 24v tension as a safety measure.

MTH

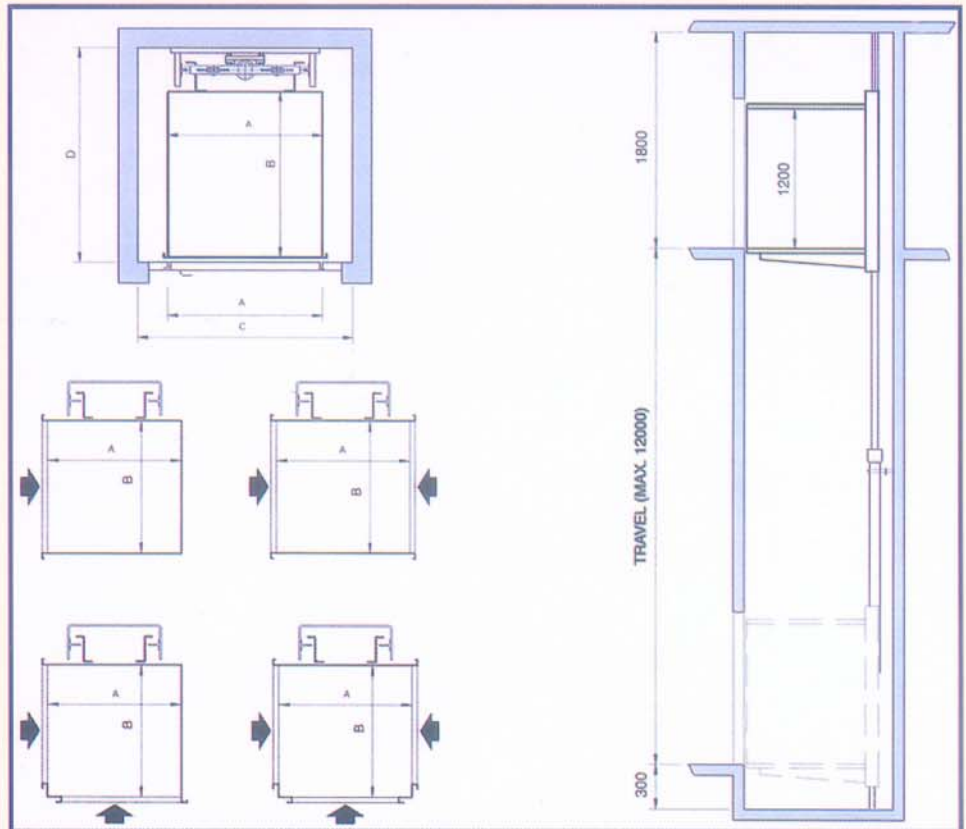

CAR AND SHAFT DIMENSIONS

Installation	A	B	C	D
FIXED ON WALL	70 - 100	70 - 100	A + 150	B+ 270
FIXED ON WALL	70 - 100	70 - 100	A + 300	B+ 360

MOTOR POWER

Model	V= 0,2 m/s	V= 0,3 m/s
MTH 200 (200Kg).	0,75 KW	1,10 KW
MTH 300 (300Kg).	1,10KW	2,20 KW

